

The "AIM Way" Reopening Plan

The next phase in reopening the AIM
Community for 2020-2021

Unwavering Commitment to Our Mission

- To *provide* extraordinary educational opportunities to children with language-based learning disabilities such as dyslexia, dysgraphia, and dyscalculia, utilizing research-based intervention strategies and an arts-based learning environment that is college preparatory in scope and sequence.
- To *develop* a center for educational excellence and professional development to disseminate best practices to educators by providing access to the latest research-based curriculum, technology, and training.

Our Commitment to Diversity, Equity and Inclusion

- We are pleased to share that **Penn Pritchard**, a longtime AIM teacher and leader of AIM's work in the DEI realm, has taken on the newly created role of Coordinator of Diversity, Equity and Inclusion.
- In recent years Penn devised and co-facilitated our Student Diversity Leadership course, organized panel discussions, and they designed DEI focused projects and promoted culturally responsive practices for all division levels
- Last year they received an MCRS@ADVIS/Carney Sandoe Equity in Action Grant and shared their work on supporting/sustaining instructional fidelity in the culturally responsive classroom at the National Association of Independent School conference.
- Penn is currently at work developing important DEI trainings for AIM faculty and staff, student programming, and implementing a new **AIM Policy on Identity-Based Discrimination and Bias**.



Key Assumptions

- **Health and Safety** of Teachers, Staff and Students is Critical.
- **Commitment to Diversity, Equity and Inclusion** whether remote or on campus.
- **Innovative Teaching** is maximized with AIM's highly-trained teachers.
- **State of the Art Technology** allows students to be taught by their highly trained teachers whether in school or at home.
- **Benchmarking and Progress Monitoring Data** and reports guide targeted instruction.
- **Evidence-Based Instruction** remains the core of our mission.
- **Signature Programs** in Robotics, Makerspace, Arts, Global Studies continue whether remote or on campus.
- **Renowned Integrated Services, College Counseling and Dual Enrollment** continue whether remote or on campus.

Key Health Protocols

- **Facial Masks Required** to be worn by staff and students on campus.
- **Symptom Self-Assessment**, including temperature checks, tracked daily.
- **6-Foot Social Distancing**: Maintain 6-foot minimum recommended distancing of students and staff throughout campus leading to reduced classroom sizes.
- **Regular Hand Washing and Hand Sanitizing Requirements.**
- **Increased Campus Cleaning and Sanitizing.**
- **COVID-19 Infection Protocol**: Isolating individuals on campus with symptoms and tracking contacts within school. Use of multiple building entrances for different divisions and staff.
- **Restricted use of Common Spaces and Visitors**– Lunches served in classroom, no on-campus Institute Training.
- **Flexibility to Switch to Remote Learning** if state mandates require.

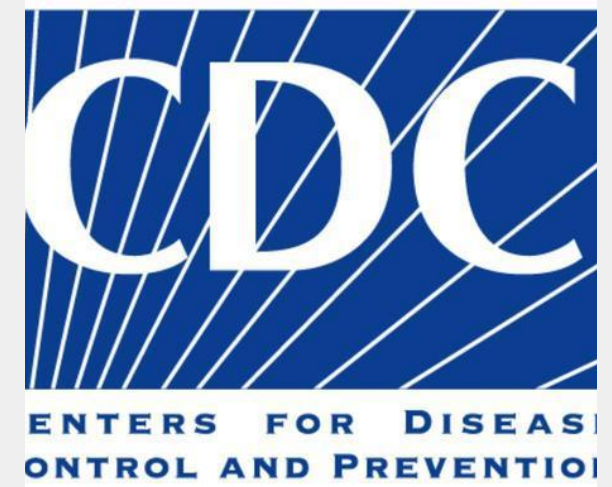

Decision Matrix

STEPS TO DECISIONS ON LEARNING FALL 2020



Governor Wolf
allows schools
in our area to
open.



AIM Learning
and Health &
Safety Plans
Comply with
State, Local and
CDC Mandates.



Executive
Leadership and
AIM Board
approves
re-opening
scenario.



Task Force
continues to
research and
modify plans as
needed.

The “AIM Way” Reopening Plan

LOWER SCHOOL

5 Days A Week On Campus

Lower School
students in-person on
campus with social
distancing and facial
coverings required.

MS/US Hybrid Model

Students divided into
groups where they will
learn on campus 3 days
a week and via live
remote learning 2 days a
week.

3-Day schedule will
alternate weekly.

100% Remote Learning Option

Students in grades 1-12
can select to attend
school via 100%
Remote Learning
connecting live with
students and teachers.

The "AIM Way" Lower School

5 Days a Week On Campus

- Provide our youngest learners the option of daily, in-person instruction and support
- Teach technology skills and use technology in classes from the start so that students learning 100% online are able to participate in each class and so that all students are learning the skills to be “remote-ready”, should Remote Learning be mandated.

Lower School

Schedule				
Monday	Tuesday	Wednesday	Thursday	Friday
In-School / In-Person	In-School / In-Person	In-School / In-Person	In-School / In-Person	In-School / In-Person

Note: If the county is in Red, Remote Learning will take place 100% of the time.

The "AIM Way" in Lower School

Build Foundational Knowledge Together

- Host required training sessions on safety protocols and new routines for students and families prior to the start of school
- Dedicate the first two weeks of school to teaching and practicing school health and safety routines, teaching technology skills, and building relationships to support strong classroom communities

Schedule Time and Space in Thoughtful, Creative Ways

- Relocate some classrooms to new spaces such as the Training Room or the Board Room to accommodate greater social distancing
- Add longer transition times between classes to allow for hand washing, students packing up their own individual materials, trips to the restroom, etc.
- Limit the movement of LS students to the lower school wing as much as possible and maximize the use of larger spaces (e.g., specials will likely be taught in the classroom rather than traveling)

The "AIM Way" Middle & Upper School

- Students divided into Blue and Gold Groups attending classes on campus 3 days a week (with classmates joining from home) and attending classes remotely (joining their on-campus classmates) 2 days a week in alternating weeks.
- State of the art technology (Meeting OWLs, 1:1 Laptop program, Zoom, NearPod, Google Classroom, etc.) allows students, regardless of setting, to have synchronous experience with peers and highly-trained teachers.
- Targeted instruction and ongoing assessment continue as part of the AIM Way model.
- Alternating Blue/Gold Wednesdays provide an additional day of in-person instruction every other week.

Schedule				
Monday	Tuesday	Wednesday	Thursday	Friday
Blue Group: In-School / In-Person	Blue Group: In-School / In-Person	Blue Group and Gold Group Alternate weeks In-School	Blue Group: Remote Synchronous Learning	Blue Group: Remote Synchronous Learning
Gold Group: Remote Synchronous Learning	Gold Group: Remote Synchronous Learning		Gold Group: In-School / In-Person	Gold Group: In-School / In-Person

Note: Wednesdays 3rd day in-person every other week.

If the county is in Red, Remote Learning will take place 100% of the time.

The "AIM Way" Middle & Upper School

- Adding longer transition times between classes and at the start and end of each day to allow for sanitizing, hand washing, packing up materials, trips to the restroom, etc.
- Special plan for the first two weeks of school to establish relationships to promote academic, social and emotional health and to practice/reinforce the routines necessary in the new environment.
- With an inevitable increase in new apps, technology, and online instructional routines, in-person learning provides an opportunity to help students troubleshoot issues with technology and become familiar with digital tools while they are still in school, hopefully making any necessary transition to remote learning all the more seamless.
- The academic benefits come from the robust, responsive, digitally-based instruction--an experience that is equitable for all students regardless of location. The benefits garnered from in-person experiences are social-emotional ones.

September 2020

Calendar for Middle and Upper School

2020-2021

Flexible Calendar Reminder and Updates

7 Labor Day SCHOOL CLOSED	Blue: Learning On-Campus	Blue: Learning On-Campus	Gold: Learning On-Campus	Gold: Learning On-Campus
	Gold: Learning At Home	Gold: Learning At Home	Blue: Learning At Home	Blue: Learning At Home
14	15	16	17	18
Blue: Learning On-Campus	Blue: Learning On-Campus	Blue: Learning On-Campus	Gold: Learning On-Campus	Gold: Learning On-Campus
Gold: Learning At Home	Gold: Learning At Home	Gold: Learning At Home	Blue: Learning At Home	Blue: Learning At Home
21	22	23	24	25
Blue: Learning On-Campus	Blue: Learning On-Campus	Gold: Learning On-Campus	Gold: Learning On-Campus	Gold: Learning On-Campus
Gold: Learning At Home	Gold: Learning At Home	Blue: Learning At Home	Blue: Learning At Home	Blue: Learning At Home
28 Yom Kippur SCHOOL CLOSED	29	30	1 October	2 <input type="text"/>
	Blue: Learning On-Campus	Blue: Learning On-Campus	Gold: Learning On-Campus	Gold: Learning On-Campus
	Gold: Learning At Home	Gold: Learning At Home	Blue: Learning At Home	Blue: Learning At Home

Why Not Offer On-Campus for All?

- Having all students on campus is our ultimate goal.
- However, in order to maintain 6-foot social distancing and the integrity of our program we are unable to bring all students across our three divisions to campus each day.
- Small classroom spaces would require older students to spend class time in large proctored spaces such as the GRC, Training Room, Board Room and Cafeteria to participate in remote learning when not scheduled in the classroom which would present significant challenges for student engagement and attention.
- The use of proctored spaces would negatively impact a student's ability to interact and collaborate with teachers and peers learning within the classroom.
- Bottom line - we weighed the benefits of more time on campus for social/emotional well being with academic integrity and felt that students would learn more from home than in a distracting environment.

The "AIM Way" Optional 100% Remote Learning

- 100% Remote Learning students will be taught by AIM teachers with live instruction allowing for interaction with teachers and students.
- Students selecting option will stay enrolled in 100% Remote through Winter Break.
- AIM is preparing individual project supply kits where appropriate to allow for even more immersive learning and student engagement whether learning at school or from home.
- Students quarantining during the 2020-2021 school year will join their regular classes by accessing 100% Remote Learning while unable to be on campus.

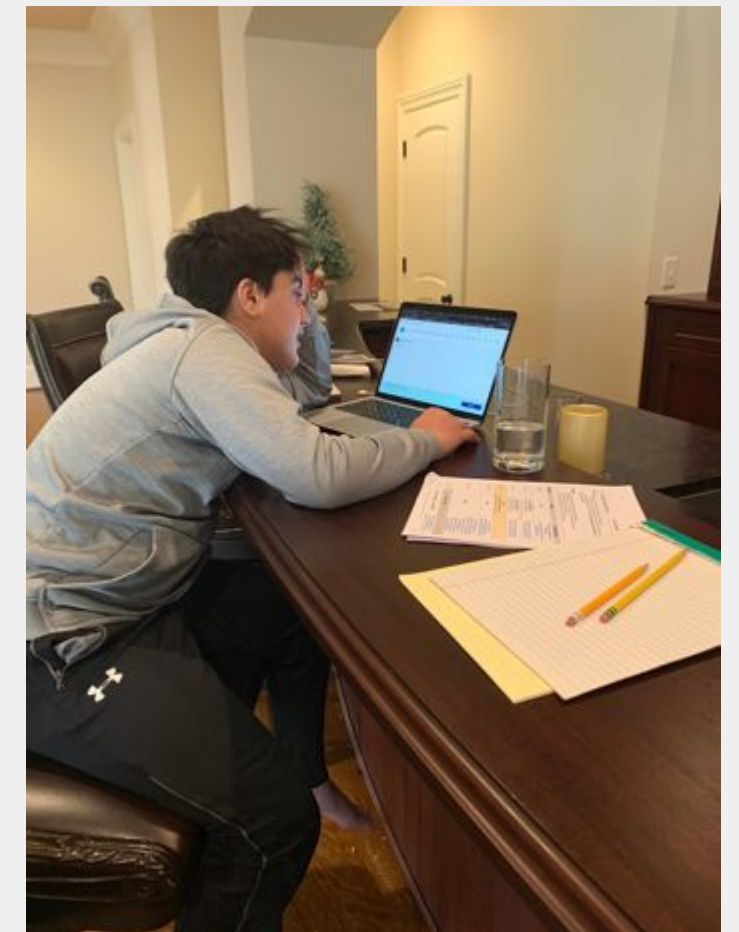
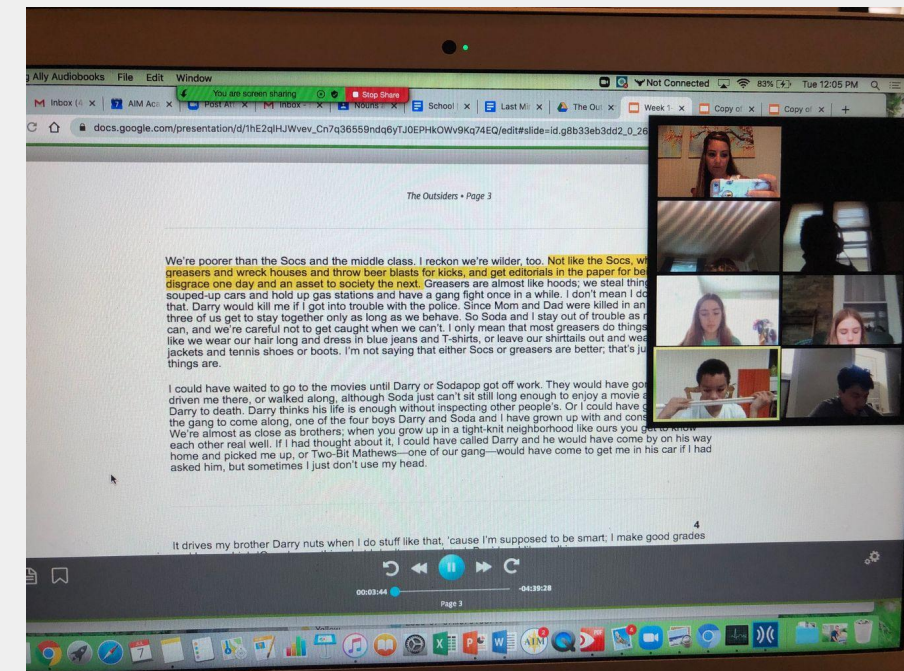

AIM Fully Remote

- AIM's decision to choose the Fully Remote option will be based on State and Montgomery County Office of Public Health guidance.
- AIM teachers are planning their work so that it can transition easily should we be required to pivot to fully Remote Learning for all AIM students.
- 2020-2021 learning model for fully remote instruction includes updates based on parent, student and faculty feedback and best practices for remote learning.

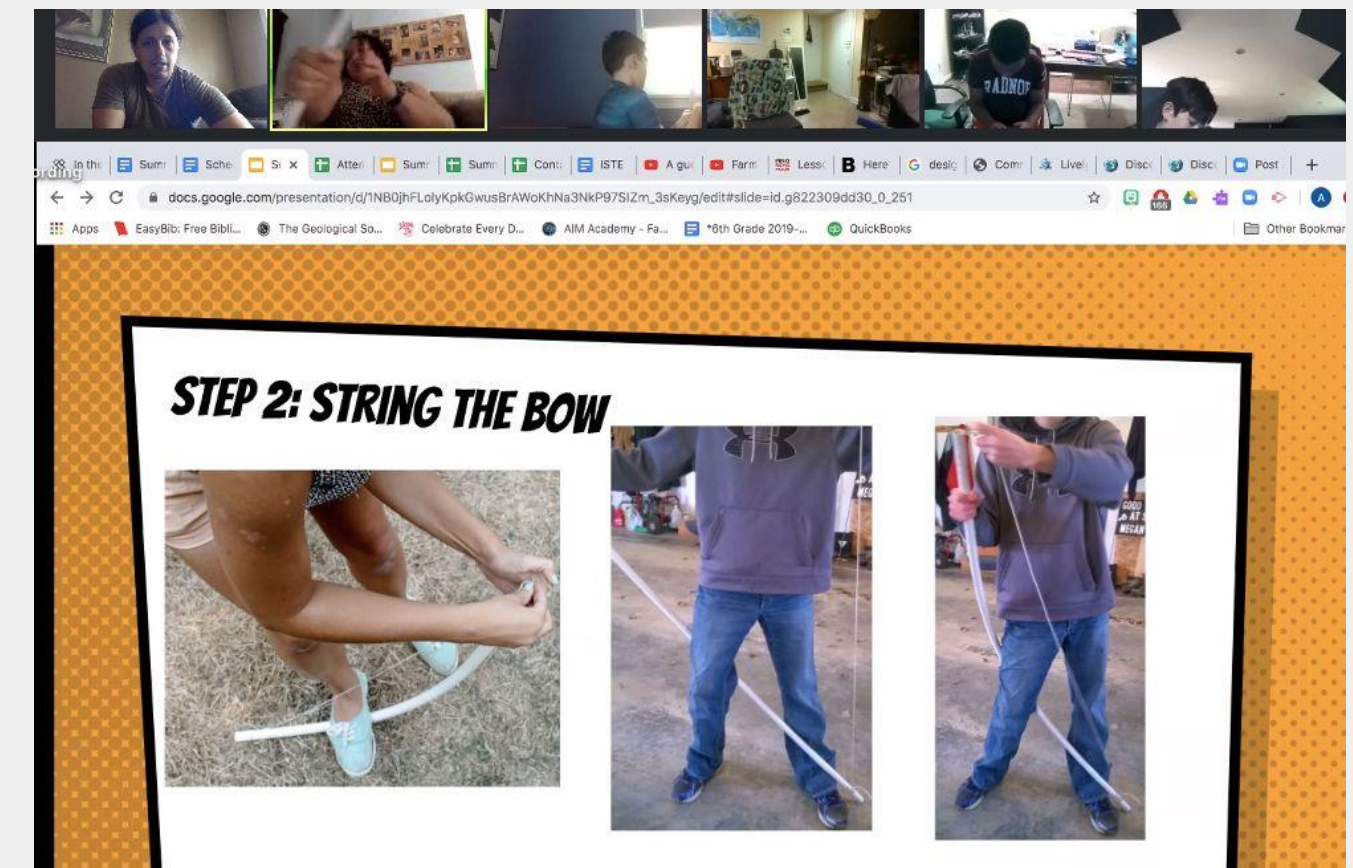



Expectations for Face Masks

In all areas inside of our buildings, we expect face masks that cover the nose and mouth to be worn including when in classrooms, meetings, and walking through common spaces.

- All faculty and staff must wear face coverings when leading and/or attending class, meeting with students or other staff members, and operating school vehicles
- Students must wear face coverings while inside school buildings including classrooms, hallways, restrooms, and common areas. Students may remove their face covering if six feet of social distancing is achieved and maintained when eating lunch (outdoors or indoors) and for designated outdoor mask breaks.
- **Face Covering Refusal:** If a student has a documented medical issue that makes them unable to comply with facial covering requirements, we will attempt to make reasonable accommodations to keep the student on campus for learning. If a student is not able or chooses not to wear an approved face covering, they may be compelled to learn remotely.
- **We continue to follow CDC, state and local health guidance on suitable face coverings and will continue to update you if there are changes. Neck and Face Gaiters are not a suitable face covering for school.**



Social Distancing

Protocols for distancing students in the classroom setting and other social distancing practices that allow for **six feet of separation** among students and staff throughout the day are expected to the maximum extent feasible.

- Clear Barriers for Teachers in Every Classroom
- Turn desks to face in the same direction or have students sit on only one side of tables to limit face-to-face seating.
- Regular monitoring for adherence to the six-foot social distancing guideline.
- Limit activities in classrooms that do not support social distancing.
- Ensure social distancing in offices and staff lounges, and during staff meetings.
- Limit large gatherings, events, and extracurricular activities to those that can maintain social distancing.
- Regular monitoring to ensure staff or students do not commune or gather in a way that is not in compliance with the social distancing protocol. Close common areas if necessary.

Social Distancing Possible Classroom Layouts

Blackney Hayes examined
our classroom spaces and
has provided
recommendations for
classroom set up
assuming a required 6 ft.
social distancing for
individuals.

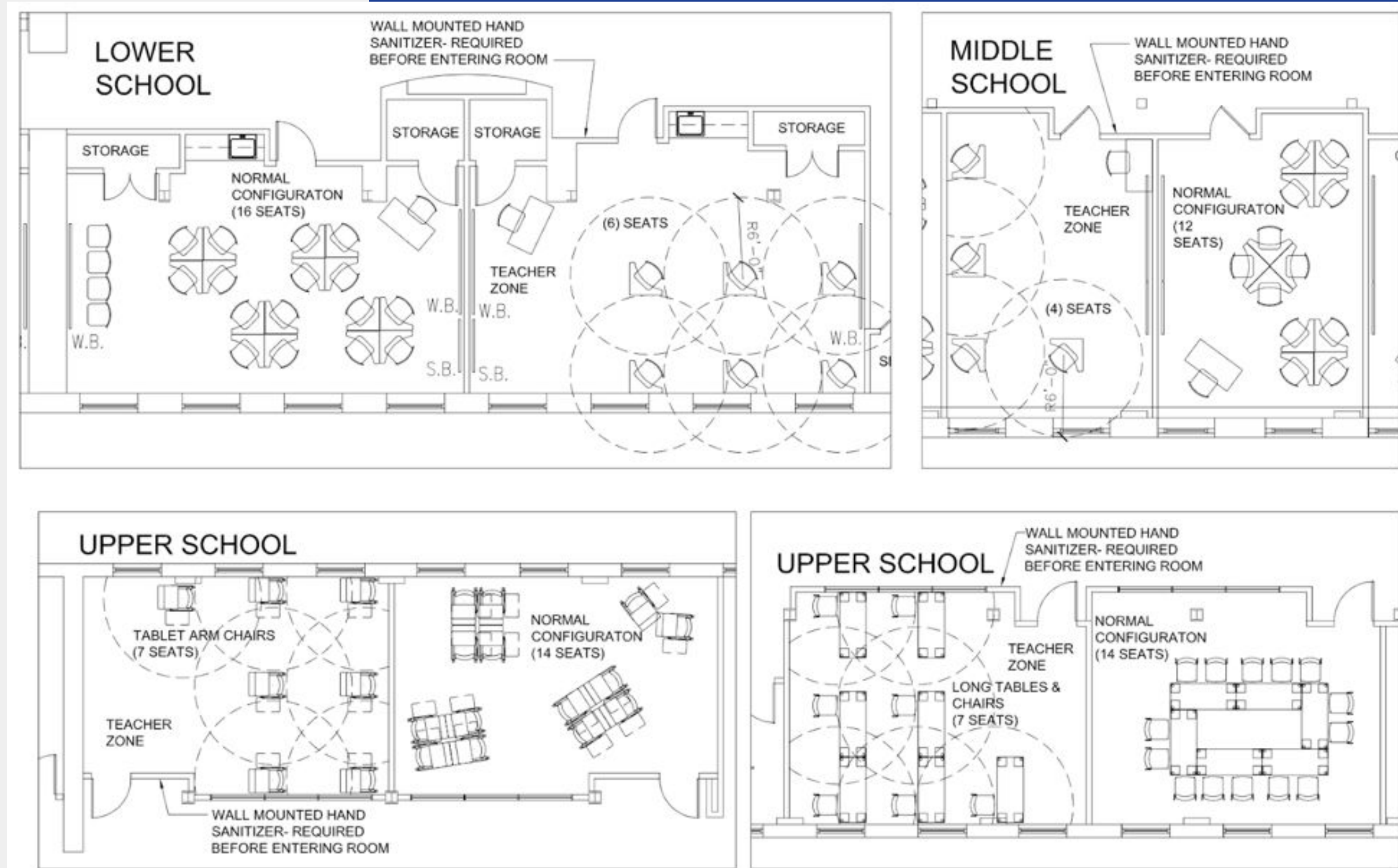

SOCIAL DISTANCING CLASSROOM LAYOUT EXAMPLES



Hand Washing and Hand Sanitizing Protocol

When handwashing, individuals should use soap and water to wash all surfaces of their hands for at least 20 seconds, wait for visible lather, rinse thoroughly, and dry with a disposable towel.

- AIM will teach and reinforce washing hands and covering coughs and sneezes among students and staff. See [CDC Handwashing Resources](#)
- Hand sanitizer will be available in common areas, hallways and classrooms, See [CDC Hand Sanitizer Use](#)
- AIM will work with local health departments and health care systems to disseminate hygiene and disinfection strategies for infection prevention at home.

Importance of Health Protocols

Michel Masters

**Division Director of Communicable Disease,
Montgomery Office of Public Health**

Campuswide COVID-19 Investments and Enhancements

- Touchless Water Faucets in Student Bathrooms
- Planned HVAC iWave Air Purification System
- Clear Barriers for Teachers in every classroom
- PPE for Health and Safety
- Cleaning and disinfecting supply stockpile
- Disinfectant misting machines
- Hiring a COVID-19 Coordinator

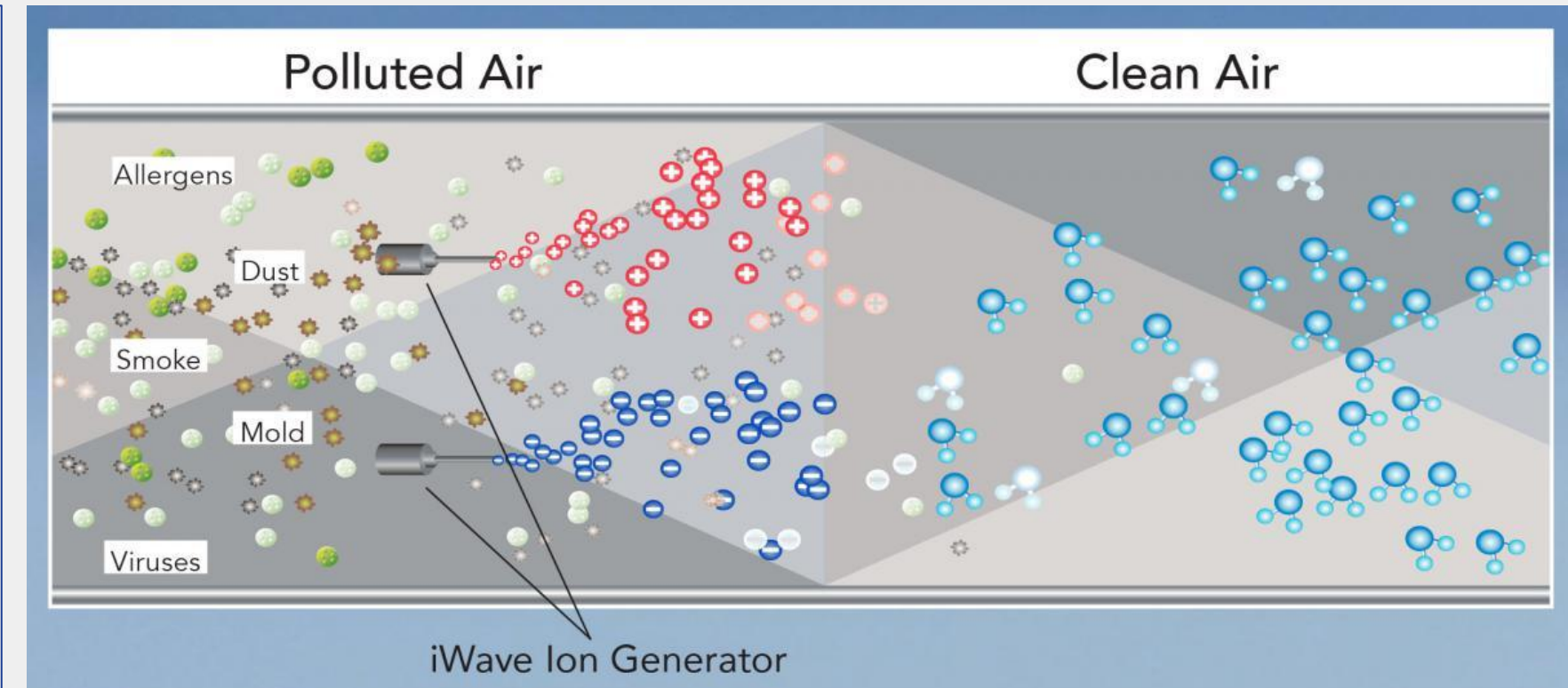

Risk Management Tools

Volo ASAP

Partnering with app-based self-symptom tracker for families and staff to use each day prior to arriving at school and to assist with contact tracing in cases of infection.

VirusSAFEPro

Using mobile-based VirusSAFEPro checklists to monitor and verify cleaning and disinfecting protocols.

Rounding

Establishing a daily staff monitoring schedule to ensure adherence to protocols such as room occupancy, hand sanitizing and masking.

COVID-19 Coordinator

Hiring a COVID-19 Coordinator to work in conjunction with school nurse and facilities director to coordinate and manage Health & Safety protocols.



All community members must partake in a self-assessment daily prior to entering the building including taking temperature.

AIM has partnered with Volo ASAP to use an app-based reporting tool that also allows us to track locations while individuals are on campus.

A smartphone screen displaying the "Covid-19 Self Assessment" survey. The status bar at the top shows the time as 12:00 and the URL "surveys.volosaaas.com". The VOLO logo is at the top of the app interface. The survey title "Covid-19 Self Assessment" is centered, with "Created 09/18/2020 at 12:00PM" below it. The first question is "1. Are you or anyone in your household feeling ill today?". There are two large, light blue buttons labeled "Yes" and "No". At the bottom, there is a light blue "Next" button and a progress indicator showing "0% Complete" with a short grey bar.A smartphone screen displaying the completion of the "Covid-19 Self Assessment" survey. The status bar at the top shows the time as 12:00 and the URL "surveys.volosaaas.com". The VOLO logo is at the top of the app interface. The survey title "Covid-19 Self Assessment" is centered, with "Created 09/18/2020 at 12:00PM" below it. A large green checkmark icon is centered above the text "Thank you for completing this survey". Below this, it says "You completed this survey". A calendar widget shows "September" in a red header and the number "18" in large black font. Below the calendar, it says "at 12:10PM". At the bottom, there is a progress indicator showing "100% Complete" with a full green bar.

COVID-19 School Exclusion Recommendations

Exclusion From and Return to School Recommendations

COVID-19 Symptoms <ul style="list-style-type: none"> • <u>Two</u> of the following symptoms: chills, fatigue, myalgia, headache, sore throat, congestion, nausea, vomiting, or diarrhea OR • <u>One</u> of the following symptoms: fever (100.4 or higher), cough, shortness of breath, difficulty breathing, or new loss of taste or smell 	<p>Individual should be tested for COVID-19.</p> <ul style="list-style-type: none"> • If test result is negative, return to school 3 days after symptoms are no longer present. • If test result is positive or individual is unable/refuses to get tested, may return to school after: <ul style="list-style-type: none"> ➤ 24 hours with no fever and ➤ Improvement in symptoms and ➤ 10 days since symptoms first appeared 	
Positive COVID-19 PCR Test	<u>WITH SYMPTOMS</u> <p>May return to school after:</p> <ul style="list-style-type: none"> • 24 hours with no fever and • improvement in symptoms and • 10 days since symptoms first appeared 	<u>WITHOUT SYMPTOMS</u> <p>May return to school after:</p> <ul style="list-style-type: none"> • 10 days after PCR test was collected <p>*If symptoms develop during the 10 days, follow return to school guidance for positive PCR <u>with</u> symptoms</p>
Close Contact to Positive <ul style="list-style-type: none"> • Within 6ft for 15 minutes or more • Household contact 	<u>WITH SYMPTOMS</u> <p>Individual should be tested for COVID-19.</p> <ul style="list-style-type: none"> • If test result is negative, return to school 14 days after last exposure to the person with COVID-19 and symptoms have resolved • If test result is positive, follow return to school guidance for positive <u>PCR</u> with symptoms 	<u>WITHOUT SYMPTOMS</u> <p>Excluded 14 days after last date of exposure to the person with COVID-19</p> <ul style="list-style-type: none"> • Household contacts are in quarantine until 14 days <u>after</u> household positive is released from isolation <p>*If symptoms develop during the 14 days, follow return to school guidance for Close Contact <u>with</u> symptoms</p>
**Travel to States with High COVID-19 Rates <ul style="list-style-type: none"> • Critical workers are encouraged to wear both a face shield and mask and social distance, if unable to quarantine 	<u>WITH SYMPTOMS</u> <p>If symptoms develop during the recommended 14 day quarantine upon return to PA, follow return to school guidance for COVID-19 symptoms</p>	<u>WITHOUT SYMPTOMS</u> <p>Self-quarantine for 14 days from when they return to PA</p>

WORK
MERK

Using mobile-based
VirusSAFEPro
checklists to monitor
and verify detailed
cleaning and
disinfecting protocols.

VirusSAFE Pro™

Address Coronavirus concerns with your workforce via WorkMerk™. Our software helps you prepare and keep your work and environment safe.

Our mobile technology provides workplace checklists and task reminders that help workers perform health and safety compliance.

Checklist recommendations by:



Other Considerations

- **Sports Programs** – will likely represent a plan delaying the start of Sports until late Fall, Winter.
- **Extracurricular Activities** will adhere to strict CDC and local authority protocols for size of gatherings.
- **Recess** will be provided outside when feasible with social distancing maintained.
- **Transportation** – Bus protocols set by each district; Train – public transit authorities will set protocols; Optional third party van service is available for parents; Carpooling and parent transportation continues.
- **AIM's team is prepared for most flexibility in delivering instruction on campus and remotely as needed.**



Lunch

Our cafeteria will not be open for student meals, however, our **AIM Kitchen** team has created a full menu of lunches (hot and cold) for the fall.

- Students will eat lunches in the classroom and can order the Lunch Program or bring their lunch to school.
- AIM Lunches will be delivered in individually-packaged containers to the classrooms using disposable utensils and containers.
- Masks may removed during lunch and students and staff will wash their hands before and after lunch.

Still Great AIM-Made Food - The lunch offerings will still include vegetarian, gluten-free, and dairy-free options (AIM's kitchen is already nut-free). Salads will be served as side dishes to some meals, but our salad bar will not be available at the start of the school year.



Next Steps and Communication

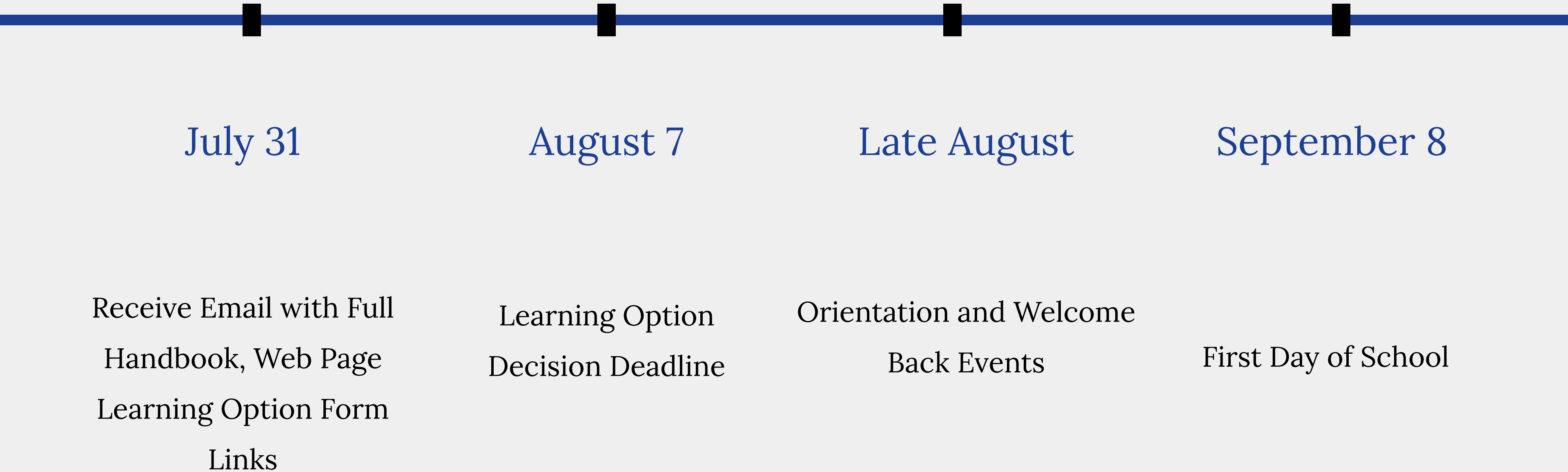

Upcoming Events and Important Dates

Division Level Summer Gatherings - Socially Distant

- Middle School - Aug 18th-20th - 4:30pm-5:30pm
- Upper School - Aug 18th-20th - 6:00pm-7:00pm

Division Level Welcome Back Events - All Virtual

- Lower School - Tuesday, Sept. 1st 5:00pm-6:00pm
- Middle School - Wednesday, Sept. 2nd 5:00pm-6:00pm
- Upper School - Thursday, Sept. 3rd 5:00pm - 6:00pm

FIRST DAY of SCHOOL for ALL STUDENTS - Tuesday 9/8

Please contact your Division Head for specific details



“I will adapt & do whatever I can without complaining if it is in the interest of making the school year SAFE for teachers, students & their families. That is my HIGHEST priority.”

Parent Survey Comment

